

Geek+

MOVING THE WORLD INTELLIGENTLY

ONE-STOP PARTNER FOR WAREHOUSE ROBOTICS

Shelf-to-Person | Tote-to-Person | Pallet-to-Person | Sorting | Moving
Robot Arm Picking Workstation



Geek+ One-stop Partner For Warehouse Robotics

Geekplus (stock code: 2590.HK) is a global leader in mobile robotics technologies. We develop innovative robotics solutions for order fulfilment. More than 850 global industry leaders use our solutions to realize flexible, reliable, and highly efficient automation for warehouses and supply chain management.

The world's Largest Warehouse Fulfillment AMR Solution Provider For Six Consecutive Years¹

850+

Trusted by 850+ global
customers

80%+

Repurchase rate²

40+

Countries
with capabilities of sales,
operations and services

1800+

Global patents

1. According to CIC, in terms of revenue from 2019 to 2024

2. As of June 30, 2025



CUSTOMER VALUE

Geekplus is committed to creating real value for companies, shaping their competitiveness through robotic fleet orchestration for order fulfillment optimization with rapid deployment. Geekplus flexible, reliable and scalable solutions help partners manage market changes with ease.



>99.99%
Accuracy



1-3 Year
ROI



1-3 Month
Rapid deployment

AWARDS



Awarded for six consecutive years
Supply Chain Excellence



Fourth time winner of RBR 50 Innovation Award



IFOY AWARD



China Most Socially Influential Startups



Forbes China
Go-international brands



Fast Company
World's Most Innovative Companies



MIT Technology Review
50 Smartest Companies



Five Years of Outstanding Industry Contribution



German Red Dot Award



Mostin Awards



Excellent Supply Chain Service Provider

CUSTOMER RECOGNITION

| | | | | | | |
|----------------|---|---|---|---|---|---|
| 3PL |  |  |  |  |  |  |
| EC |  |  |  |  |  |  |
| Retail |  |  |  |  |  |  |
| Apparel |  |  |  |  |  |  |
| Pharmaceutical |  |  |  |  |  |  |
| Manufacturing |  |  |  |  |  |  |
| Automotive |  |  |  |  |  |  |

GLOBAL SERVICE

Geekplus provides reliable, comprehensive high quality service to fully realize optimized system availability and system efficiency.



< 10 Min
Online customer inquiries response time

52+
Global service stations and service partner sites

7 x 24 Hour
Global technical support

12
Global spare parts centers

One-Stop Smart Warehouse Solution

Shelf-to-Person | Tote-to-Person | Pallet-to-Person | Sorting | Moving | Robot Arm Picking Workstation



Industry-Wide Application

Designed to meet the unique needs of any sector.



Scalable & Flexible

Build your ideal setup with our modular solutions.



Seamless Integration

One system to efficiently coordinate all robot types.



Battle-Tested Reliability

Trusted by industry leaders worldwide.

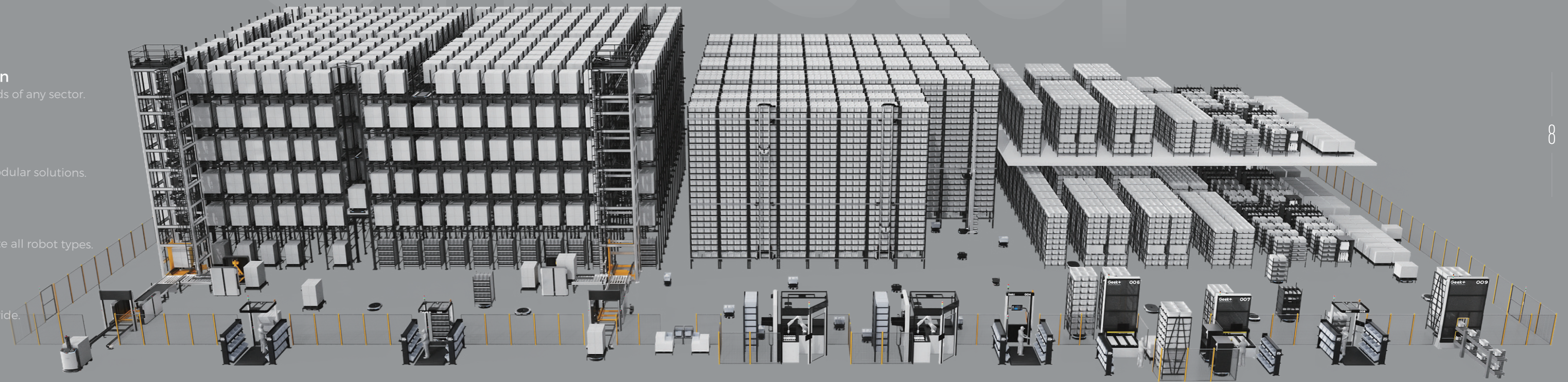

Solving the Large-Scale Goods Picking Challenge

Fully Automated Picking: Robot Arm Picking Station

The all-new Geek+ Robot Arm Picking Station features a combination of advanced vision systems, robotic arms and can be paired with our Goods-to-Person solutions. We solve the core problem of grasping diverse items with plug and play functionality, enabling fully automated, high-adaptability, 24/7 order picking across all product categories and scenarios.



Scan for Full Details

Plug-and-Play

No post-deployment training required

1-2 Years

ROI

Safe & Secure

Localized Deployment

Full-Category Compatibility:

Suitable for diverse industry scenarios



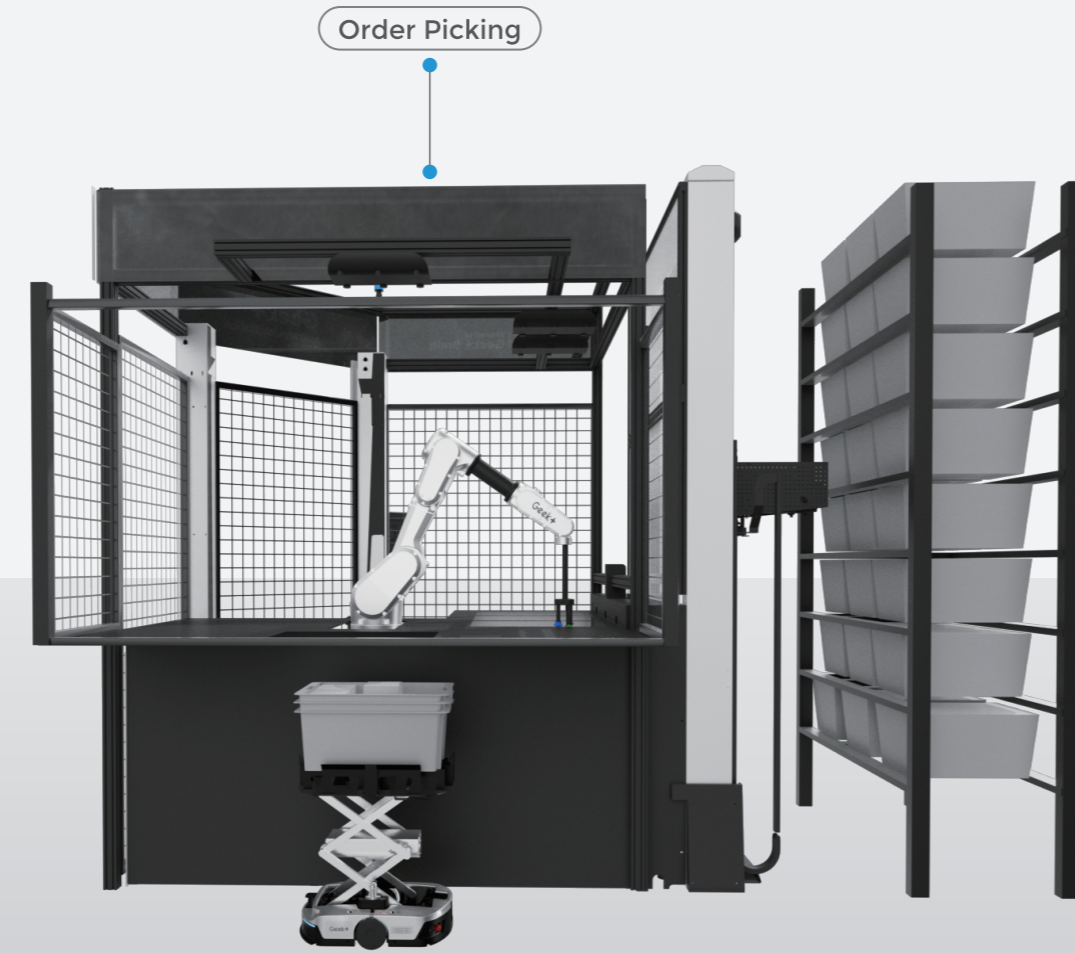
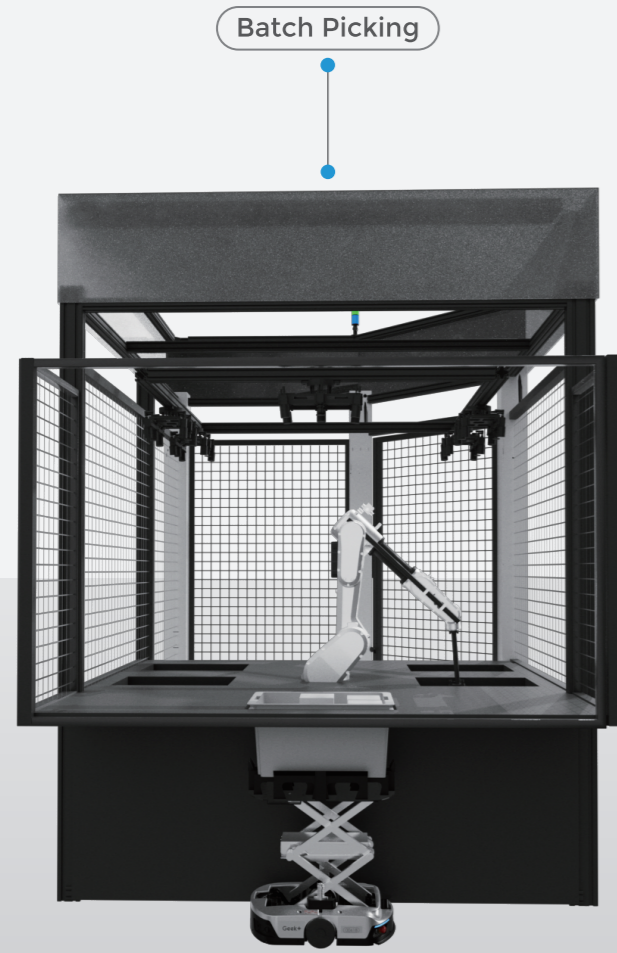

Solving the Large-Scale Goods Picking Challenge

Fully Automated Picking: Supporting Multiple Picking Solutions

Supports flexible deployment of multiple picking modes, 7x24 continuous operation, ensuring safety, reliability, and efficiency multiplication.



Scan for Full Details

Order Picking

- Focus on "Instant Response"
- Multi-order tote ports enable picking directly to individual orders, supporting 20+ orders simultaneously. Completed orders are directly sent to packing stations, eliminating the need for secondary sorting.
- Ideal for scenarios requiring extremely high timeliness and dealing with fragmented order volumes, minimizing the processing cycle for individual orders.

Batch Picking

- Focus on "Maximum Efficiency"
- Multiple orders are processed collectively, prioritizing the batch picking of similar items before order sorting.
- Suited for scenarios with concentrated order volumes and high SKU repetition, where certain preprocessing time is acceptable

High Flexibility, Rapid Convenience

PopPick Shelf-to-Person Picking Solution

High Flexibility | Easy Deployment | High Throughput



Scan for Full Details



PopPick Lite Workstation



Shelf



Charge Station



P Series Picking Workstation



P800 P1200



WES



RMS

Geekplus' s disruptive innovative PopPick Shelf-to-Person Solution enables robots to automatically transport shelves to picking workstations, establishing an efficient and accurate shelf-to-person operation mode, which fundamentally optimizes the picking process. This solution mainly consists of PopPick workstations, P-Series workstations, P-Series picking robots, and a mixed storage system for containers/shelves/pallets. Its three core advantages are obvious: comprehensively upgraded efficiency, stronger compatibility, and faster deployment speed, helping warehousing scenarios quickly achieve intelligent transformation.

2-4 W
Rapid
Deployment

2-4x
Efficiency
Upgrade

2-3x
Storage
Improvement

99.99%
Accuracy

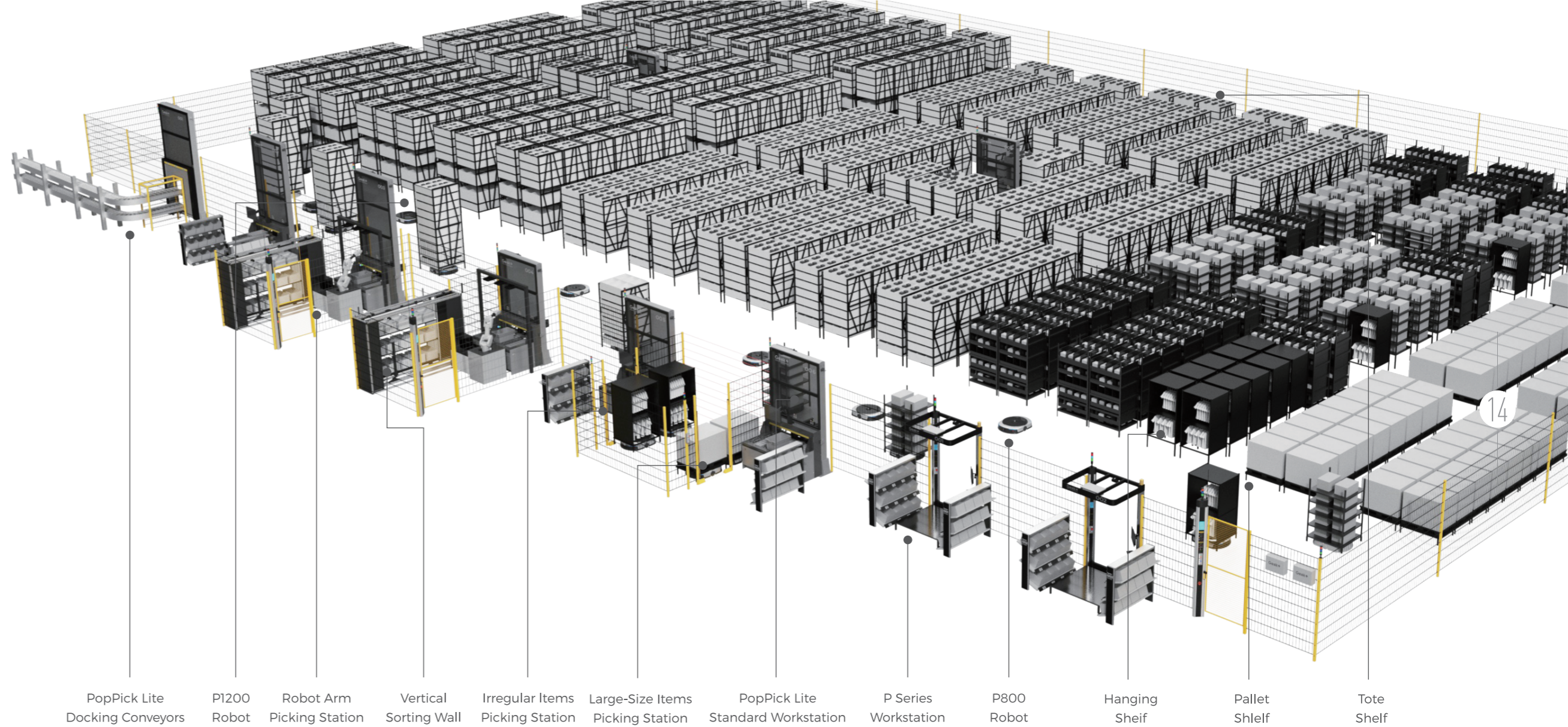

PopPick Lite Docking Conveyors

P1200 Robot

Robot Arm Picking Station

Vertical Sorting Wall

Irregular Items Picking Station

Large-Size Items Picking Station

PopPick Lite Standard Workstation

P Series Workstation

P800 Robot

Hanging Shelf

Pallet Shelf

Tote Shelf

Three vehicle hybrid operation, balancing throughput and storage

RoboShuttle Tote-to-Person Picking Solution

High Storage | High efficiency | High Flexibility

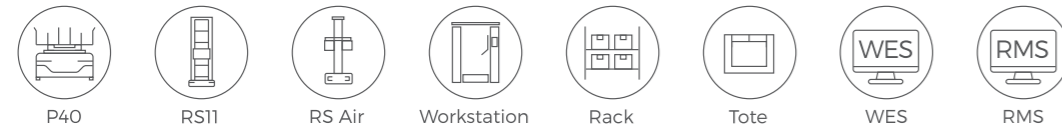

Geek+ RoboShuttle is a next-generation, high storage density, tote-to-person picking solution with optimal cost efficiency and robust operational flexibility. The solution combines the advantages of several robots: RS moves totes from storage rows for collection, RSAir robots to efficiently and quickly process stable daily inventory of A-class SKUs, and P40 swiftly carries the totes to an operator at a picking station. This combination of robots work together to achieve maximum efficiency.

5x
Storage
Enhancement

3-4x
Efficiency
Improvement

99.99%
Accuracy



Scan for Full Details

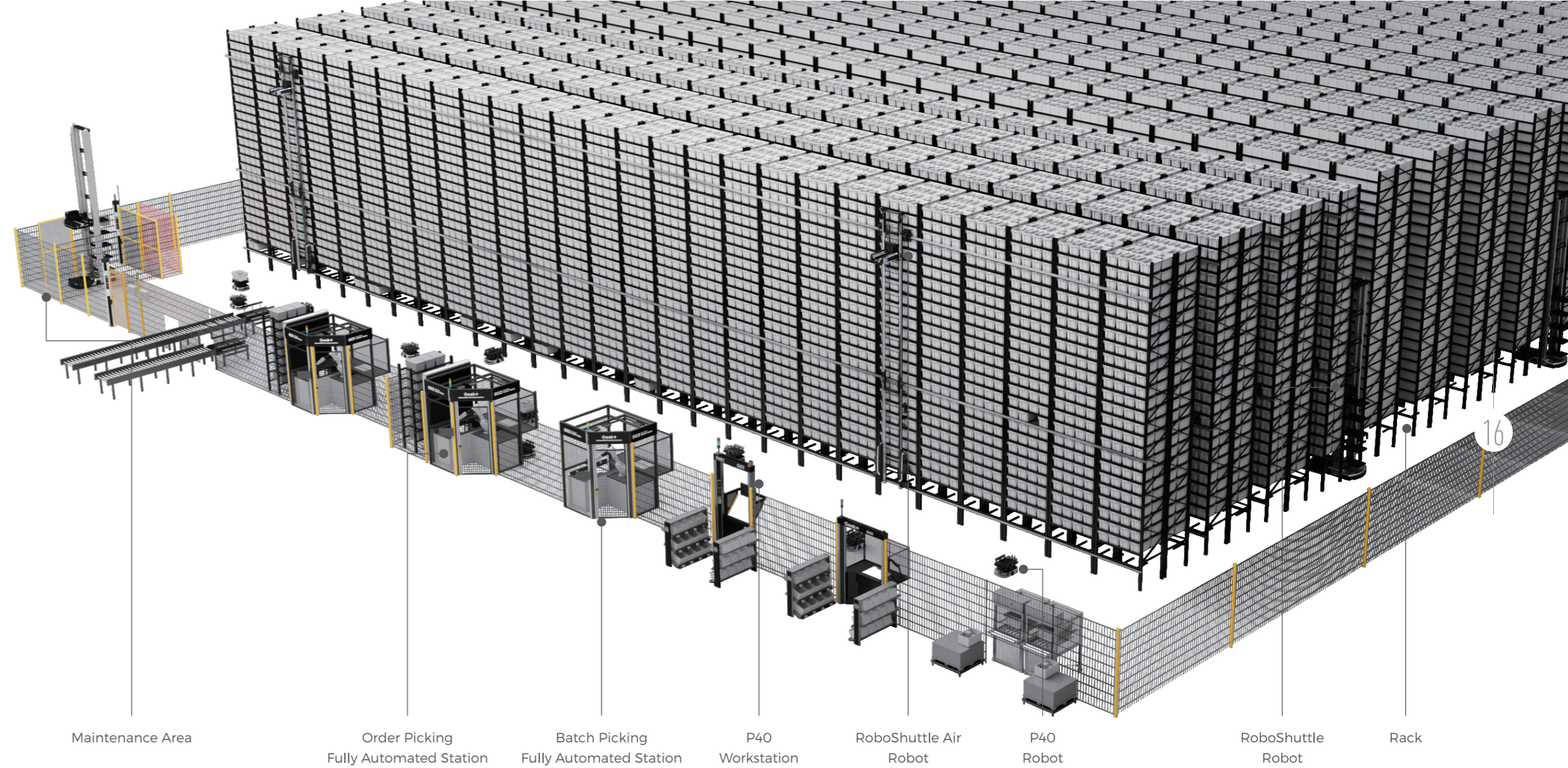

Integrated scheduling for greater efficiency and density

SkyCube Pallet-to-Person Picking Solution

High Density Storage | High Efficiency Picking | Integrated Scheduling



Scan for Full Details



X1200 Robot



P800 Robot



Elevator



Picking Workstation



Conveyor Line



Four-way Shuttle Racks



Rack



Charging Station



IWMS



WES



RMS

SkyCube integrates storage and picking in one automated system. The solution uses X-Series storage robots for high-density pallet handling, P-Series robots for transport, and coordinating lifts for cross-floor movement. Capable of integrating pallet handlers and robotic arms, it enables fully unmanned operations from receiving to dispatch.

5-8x

Increased Storage Capacity

2-3x

Increased Picking Efficiency

99.99%

Accuracy

3-4Y

High ROI

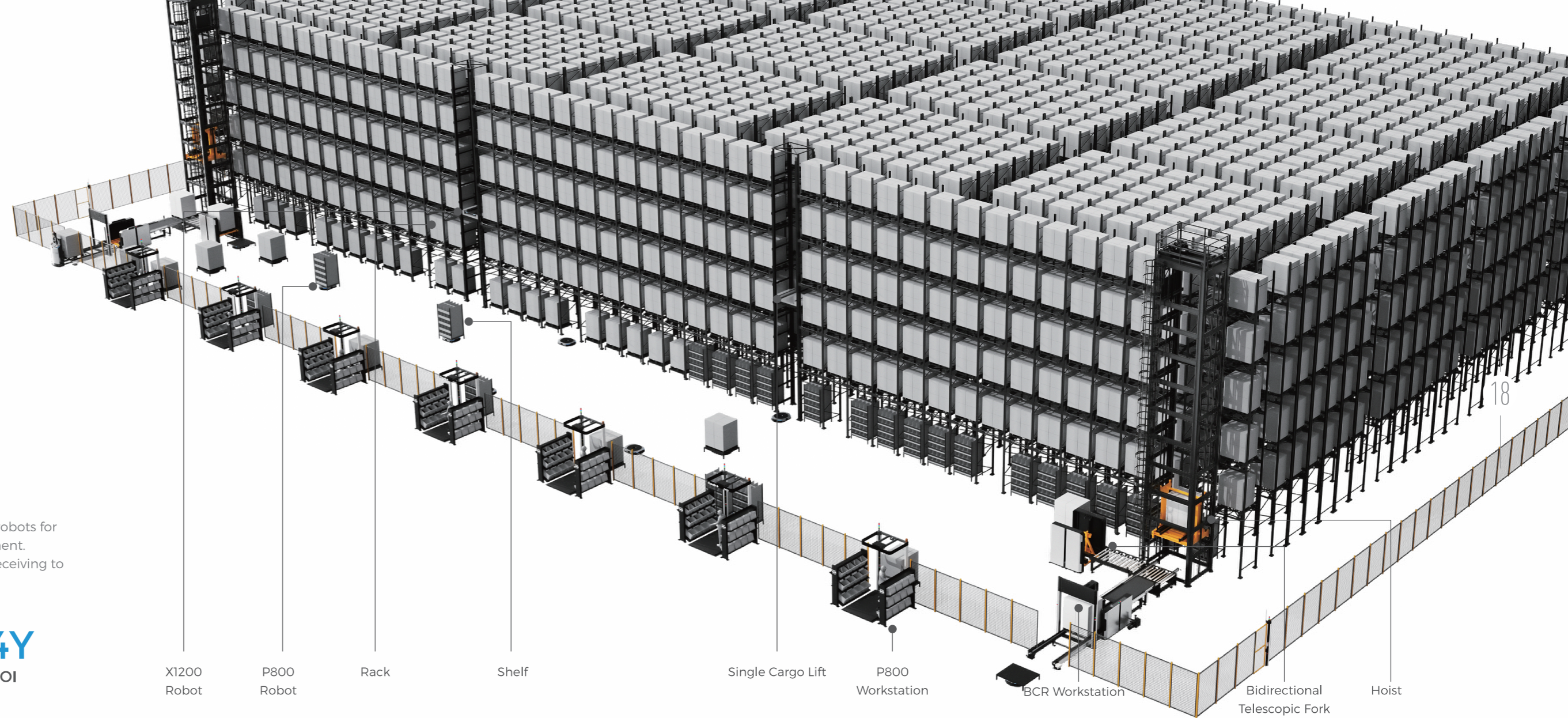

X1200 Robot

P800 Robot

Rack

Shelf

Single Cargo Lift

P800 Workstation

BCR Workstation

Bidirectional Telescopic Fork

Hoist

18

Unlock Greater Intelligence with Modular Solutions

FleetSort Sorting Solution

Order Batching | Two-Stage Sorting | Scalable Expansion



Scan for Full Details

FleetSort is an innovative intelligent sorting solution. Its core strategy involves "first consolidating orders for batch processing, then executing automated precision sorting." By combining upstream order optimization with downstream efficient sorting, it effectively breaks through the efficiency limitations of traditional picking models. This helps customers significantly enhance order processing capacity within limited spaces, reduce overall operational costs, and achieve smarter, more flexible warehouse automation.

+50% Throughput
in the Same Floor Space

Higher Cost-Efficiency
at the Same Throughput

Flexible Adaptation to Business Needs
with configurable wave and sorting strategies

Unlock Greater Intelligence with Modular Solutions

Smart Material Handling Solution

Precision-Tailored for Diverse Scenarios



Scan for Full Details

InstaMove Agile Material Handling Solution

Ideal for small-scale operations with up to 10 robots, InstaMove enables rapid automation with minimal investment, delivering quick returns through streamlined deployment.

Rapid Deployment

Built-in Flexibility

Ideal for Small/Medium Projects

MPX Flexible & Customizable Robot Platform

Built on a proven mobile robot model, the MPX platform offers modular customization of size and payload to fit diverse operational layouts—delivering efficient, cost-effective automation tailored to your needs.

Flexible Customization

Proven Reliability

Safety & Robustness

Intelligent Forklift Solution

Equipped with laser SLAM navigation for installation-free deployment, this intelligent forklift ensures safe operation with 360° obstacle avoidance and a 3m lift / 2t capacity—providing efficient and adaptive pallet handling without infrastructure changes.

Works Anywhere

Precision & Efficiency

Operational Safety

Geekplus System Software Platform

Driven by both algorithms and data, it is jointly built by the three core components: WES, RMS, and IOP. The system is highly modular and provides flexible open interfaces, making it easy for customers and partners to use and integrate. After 10 years of continuous refinement with over 1,000 customers, it has accumulated the best practices in warehouse operations from leading enterprises across various industries worldwide.



Scan for Full Details

Intelligent & Efficient

Ultimate Algorithm
10-Year Data-Trained

300%
3x Manual Efficiency

Intelligent Scheduling
Maximize Picking Efficiency

Secure & Reliable

Information Security
Full-Coverage Security Mechanisms

99.998%
Uptime

10 Min
Rapid Recovery

General & Open

0.5 Day
Software Implementation & Configuration

1 Hour Training
Enjoy Intelligent Warehousing Immediately

Easy & Friendly

1000+
Industry leader Verification

Fast Seamless Integration
Support Custom Development

Warehouse Execution System

Heat Management:

Heat management based on intelligent outbound prediction, which reasonably distributes boxes with different heat levels in the warehouse to maximize the handling efficiency of robots.

Task Balance:

Intelligent task balancing algorithm, maximizing robot density and throughput under the same area

Dynamic Slotting:

Automatic slotting can be carried out at night or during idle time to achieve optimal inventory, shorten the handling distance, and maximize the utilization rate of robots.

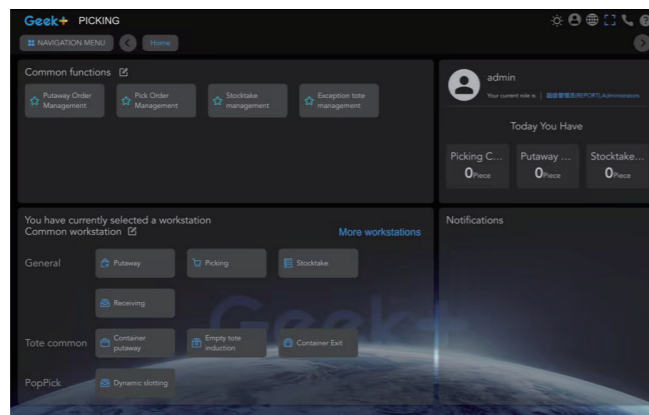

WES

Robot Management System

Large-Scale Scheduling:

It can schedule more than 5,000 robots simultaneously, effectively supporting various robot combination schemes.

Dynamic Planning:

Real-time processing of traffic management and task allocation for large-scale mobile robot clusters to optimize production capacity

Open & User-Friendly:

Support black-box, gray-box, and white-box integration

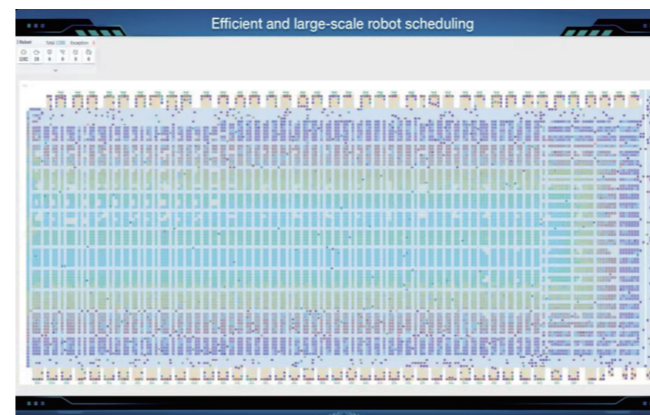

RMS

Intelligent Operation Platform

Visual Data Analysis:

Facilitate business decision-making and operational optimization

Large Screen Dashboard:

Warehouse indicators are clearly visible at a glance

Abnormal Alarm:

Real-time automatic detection of abnormal conditions to prevent production interruptions

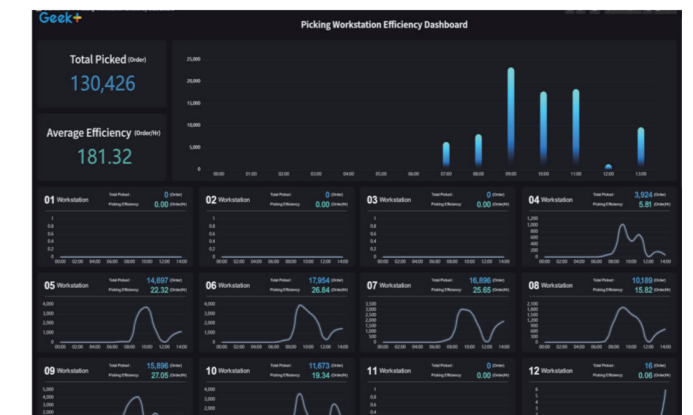

IOP

Geekplus Safety Solution



The complete system safety solution has passed TUV Rheinland certification and can provide safety protection with a functional safety level as high as PLd.

Geekplus focuses on **People-oriented**, Professional safety design, safety research and development, safety implementation, and safety verification teams ensure the security of each project.

Minimal Installation

Safety component plug-and-play, single project with single security controller

Easy to Debug

Rapid output of visualized data reports on the operating status of safety systems

Highly Available

Supporting regional safetystop function to reduce the impact on the availability of system emergency stop

Safety Door

Cleaning/abnormal handling ops adopt interlocking protection (safety PLC-controlled, protective locking) to ensure safe personnel access to robot area

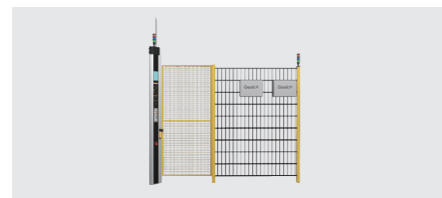

Picking/Putaway Workstation

Picking/Putaway uses safety light curtains for intrusion detection and picker interaction safety

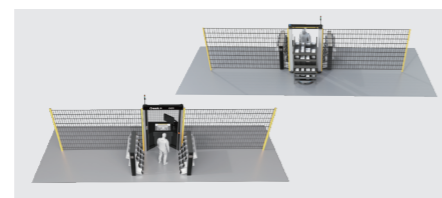

Maintenance Area

Maintenance uses a dedicated robot channel with special structure plus pedestrian-vehicle separation for safe maintenance space

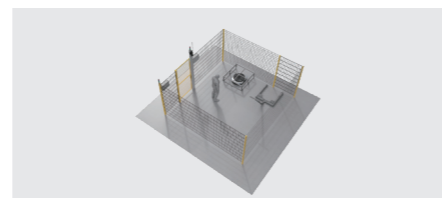

Overall Area

Use safety fences as safety protection devices to construct an unmanned scene

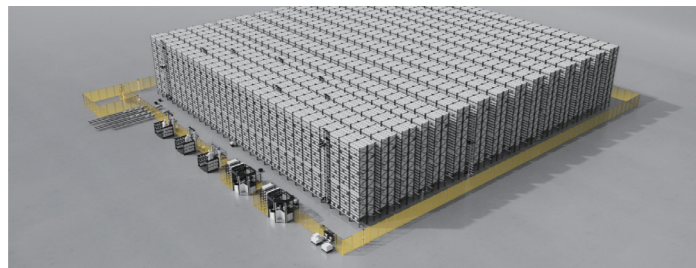

RoboSafe (Optional)

Advanced protection features safety belts for maintenance personnel's site entry, securing human-machine collaboration



Information Security



Customer Values

Security Compliance

Data Protection

Business Continuity

SOP

Vulnerability Management

Disaster Recovery Plan

Incident Response Plan

Geek+ Security Framework

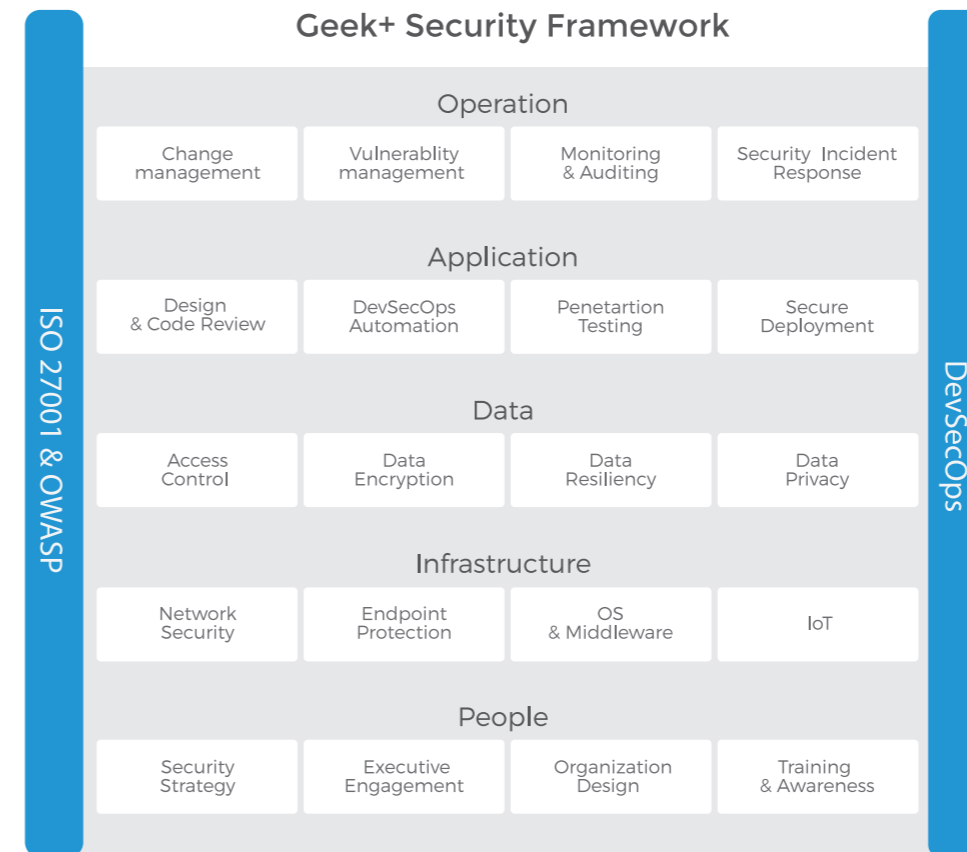

Security Principles

- Least privileges
- Least exposure
- Layered defense
- Zero Trust

Awareness and Culture

- Shift-left strategy
- Awareness and skill training
- Security-aware culture
- Embrace industry best practices

 Household Chemicals & Cosmetics

Household Chemicals & Cosmetics Success Case —

Unilever is one of the world's largest consumer goods companies, with its products sold in over 190 countries and regions around the world.



Scan for More Industry Cases

Customer Pain Points

- Traditional warehouses struggle with efficiency, space use, and safety.
- The existing model only handles B2B operations and can't support B2C fulfillment.
- B2C orders require faster fulfillment.

Solution

- B2B Storage and Picking: SkyCube Pallet-to-Person Picking Solution (X1200 Robot + P800 Robot + Rack + Hoist + WES system + RMS system)
- B2C Storage and Picking: RoboShuttle Tote-to-Person Picking Solution (RS-series Robot + P-series Robot + Picking Workstation + Rack + WES system + RMS system)

Customer Value

 **50%** ↑
Storage Capacity

 **200%** ↑
Operatioanl Efficiency

 **4 Times Repurchase**
High Recognition



Tote-to-Person Picking Solution + Pallet-to-Person Picking Solution

Hybrid solution

B2C Order Picking Area

B2B & B2C Storage Area



Retail

General Merchandise Success Case —

Watsons is a globally renowned health and beauty retailer. It was founded in Hong Kong in 1841 and offers a wide range of products including beauty, personal care, and health items. As a benchmark brand leading the global beauty retail industry, Watsons has always taken consumer experience as its core engine and driven sustainable growth with forward-looking technology.



Scan for More Industry Cases

Customer Pain Points

- Inventory Management Dilemmas: Omnichannel operations involve a large number of SKUs, manual warehouses have low storage density and space waste.
- Fulfillment Efficiency Bottlenecks: Low efficiency of manual picking, poor timeliness, and difficulty in ensuring accuracy.
- Sustainable Development Pressures: High warehouse energy consumption and high dependence on labor.

Solution

- PopPick Shelf-to-Person Picking Solution (PopPick Picking Workstation + P-Series Robot + WES System + RMS System)
- Spatial Revolution: BC Mixed Storage, One Solution for Large, Medium and Small Items
- Efficiency Leap: Dynamic slotting, High Hit Rate, Fast Picking Speed, Saving Manpower and Number of equipment
- Sustainable Intelligent Transformation: Flexibility, Energy Saving, Rapid Deployment

Customer Value



10-20 Totes

Shelf Hit Rate



Repurchase

High Customer Satisfaction



3x

Picking Efficiency Improvement



 Footwear and Apparel Industry

Apparel Success Case — Cross-Border E-commerce



Scan for More Industry Cases

A Chinese cross-border B2C Internet company established in 2008, its business is mainly for consumer markets such as Europe, America and the Middle East. Clothing stocking warehouse for picking warehouses, e-commerce platform for overseas markets.

Customer Pain Points

- High turnover and high capacity (over 400,000 inventory totes in 5 days), High timeliness requirements for fulfillment

Solution

- RoboShuttle Tote-to-Person Picking Solution (RS-Series Robot + P-Series Robot + Picking Workstation + Rack + WES System + RMS System)

Customer Value



4-5X ↑
Storage Capacity



250% ↑
Picking Efficiency



60% ↓
Reduce Staffing Requirements





3PL Success Case — WINIT 万邑通 WINIT CORPORATION

Winit is an enterprise in China that specializes in providing overall supply chain solutions for cross-border e-commerce. It is also one of the first batch of outstanding overseas warehouse practice cases of the Ministry of Commerce.



Scan for More Industry Cases

Customer Pain Points

- High throughput
- Availability of multi-client systems
- Timeliness

Solution

- RoboShuttle Tote-to-Person Picking Solution (RS-Series Robot + P-Series Robot + Picking Workstation + Rack + WES System + RMS System)

Customer Value





Manufacturing Success Case — SIEMENS

SHVS, a Siemens-Shanghai Electric joint venture, specializes in 6-24kV medium-voltage switchgear, covering design, production, and service.



Customer Pain Points

- 300,000+ SKUs with complex material management
- Low efficiency and high error rates in manual operations
- Insufficient storage space, high cost of external warehouses

Solution

- Receiving: F12ML + P800 handle intake and quality checks
- Storage & Picking: Large/irregular items: High-level steel platform storage; Medium items: X1200 + P800 for dense access; Small items: RS8 + P40 for picking and outbound
- Feeding to Production: MP1000R + P800 enable seamless line supply

Customer Value

